



Certificate No. FM163

ISO 9001

FT 43 Ball Float Steam Trap DN 15-50

Description

The FT43 is an iron ball float steam trap with integral automatic air venting facility. It is available with horizontal flanged connections as well as vertical flanged connections designated FT43V. As an option in the horizontal version a manually adjustable needle valve can be added for use as a steam lock release designated FT43-C. If required the cover can be drilled and tapped $\frac{3}{8}$ " BSP or NPT for the purpose of fitting a drain cock.

Limiting conditions (ISO 6552)

Maximum body conditions PN 16
PMA — Max. allowable pressure 16 bar g
TMA — Max. allowable temperature 220°C
Cold hydraulic test pressure 24 bar g

Operating range

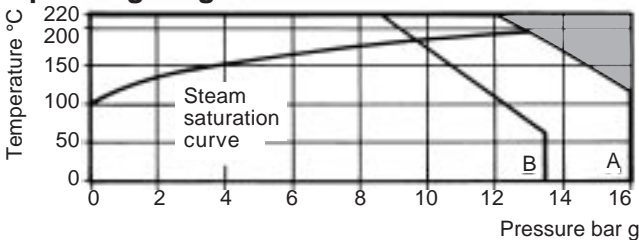

A Flanged BS 4504 PN 16
B Flanged ANSI 150 flat face (DN15 and 20), ANSI 125 (DN25 to 50)

The product must not be used in this region

Δ PMX - Max. different pressure

DN	FT43-4.5	FT43-10	FT43-14
15 to 50	4.5 bar	10 bar	14 bar

40/50DN traps are limited to a PMO equal to Δ PMX.

Sizes and pipe connections

DN 15, 20, 25, 40 and 50 Standard Flange BS 4504 and PN 16. On request ANSI 150 flanges with drilled and tapped holes can be provided.

Materials

No.	Part	Material	Specification
1	Body	Cast Iron	DIN 1691 GG 25
2	Cover Bolts DN 15-25	Steel	BS 3692 Gr.8.8
	Cover Stud	Steel	BS 3692 Gr.8.8
	Cover Nuts		
3	Cover Gasket	Reinforced Exfoliated Graphite	
4	Cover	Cast Iron	DIN 1691 GG 25
5	Valve Seat DN 15,20,25	Stainless Steel	BS 970 431 S29
	(On DN 15 and 20 vertical traps with erosion deflector)		
	Main Valve Assembly with Erosion Deflector DN 40, 50	Stainless Steel	BS 3146 Part 2 Anc 2
6	Valve Seat Gasket	Stainless Steel	BS 1449 304 S11
	DN 15, 20, 25		
	Main Valve Assembly Gasket	Reinforced Exfoliated Graphite	
7	Pivot Frame Assembly	Stainless Steel	BS 4183 18/8
	Bolts DN 15,20,25		
	Main Valve Assembly Bolts DN 40		BS 970 304 S16
	Studs & Nuts DN 50		BS 6105 A4.80
8	Ball Float & Lever	Stainless Steel	BS 1449 304 S16
9	Air Vent Assembly	Stainless Steel	
11	SLR Assembly	Stainless Steel	BS 970 303 S21
12	SLR Gasket	Mild Steel	BS 1449 CS4
13	SLR Seal	Graphite	
14	Support Frame	Stainless Steel	BS 1449 304 S16
15	Pivot Frame	Stainless Steel	BS 1449 304 S16
16	Pivot	Stainless Steel	

FT 43
DN 15 & 20

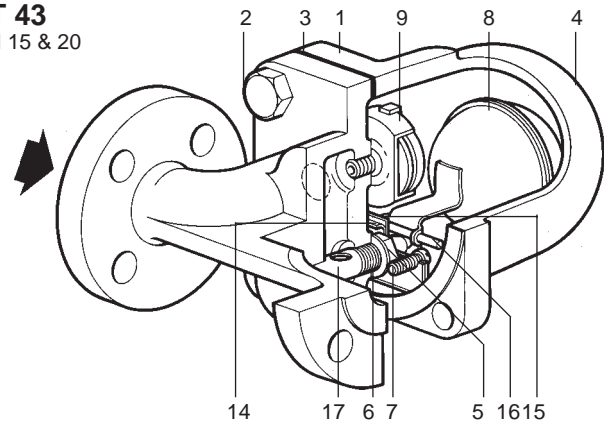

FT 43
DN 25

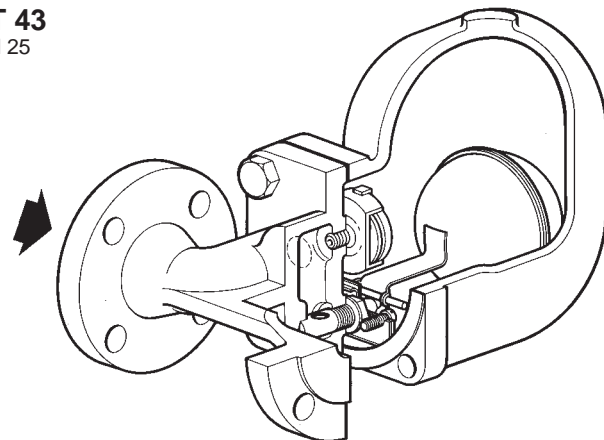

FT 43
DN 40 & 50

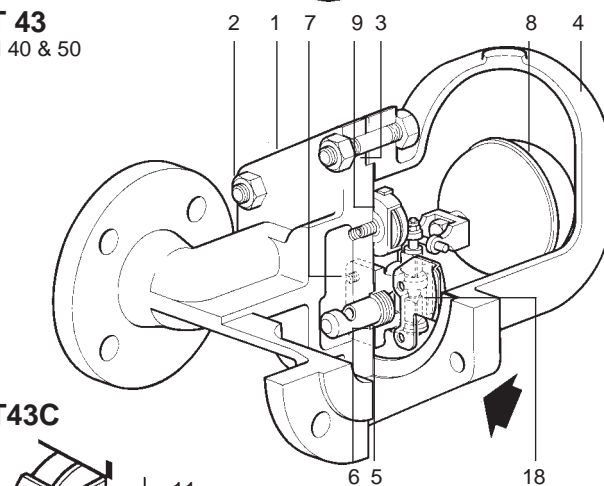

FT43C

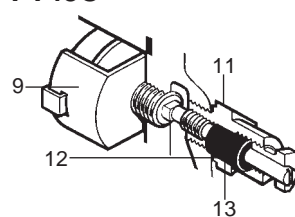

17	Erosion Deflector	Stainless Steel	BS 970 431 S29
	(DN15, 20 and 25 horizontal and DN15 and 20 vertical traps only).		
18	Inlet Baffle (DN40 and 50)	Stainless Steel	BS1449 304 S15

How to specify

DN 20 SPIRAX SARCO FT 43-14 Steam Trap. Flanged to BS 4504, PN 16 with Cast Iron body and cover and thermostatic air vent.

Dimensions (approximate) in millimetres

DN	A	B	C	D	E	F	Weight
15	150	54	54	188	110	155	5.5 kg
20	150	54	54	195	110	165	5.5 kg
25	160	110	80	245	160	215	8.3 kg
40	230	128	110	330	200	200	21.5 kg
50	230	140	126	340	200	225	30.5 kg

Face to face dimensions in accordance with ISO 6554

Installation

The trap must be fitted with the direction of flow as indicated on the body, and with the float arm in a horizontal plane so that it rises and falls vertically.

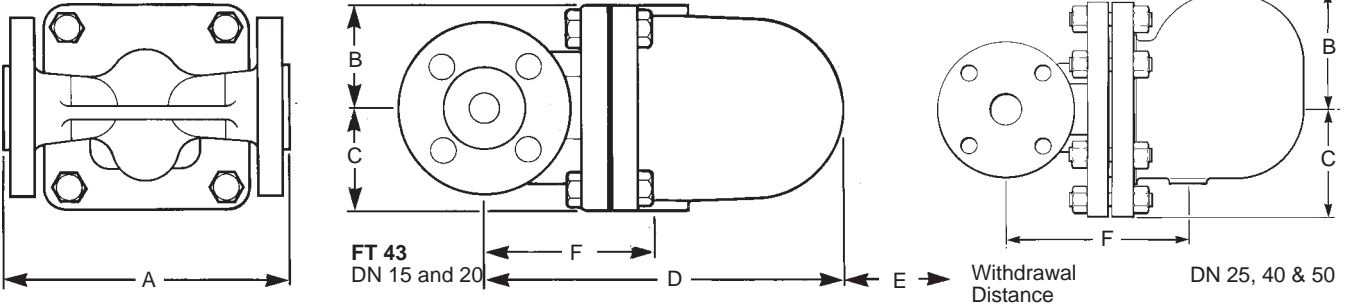

Spare parts

The spare parts available are shown in heavy outline. Parts drawn in broken line are not supplied as spares.

AVAILABLE SPARE

Main Valve Assembly with Float (DN 15, 20, 25 horizontal traps)*	5,6,7,8,14,15,17
Main Valve Assembly with Erosion Deflector** (DN 40, 50) (specify horizontal or vertical trap)	5,6,7
Main valve assembly with float and erosion deflector (DN 15 and 20 vertical traps only)	5,6,7
Ball Float and lever (DN 40 and 50)	8
Air Vent Assembly	9
Steam Lock Release and air vent assembly	9,11,12
Complete Set of Gaskets (Pkt of 3 Sets)	6,12,13

* On horizontal traps the erosion deflector on the DN 15, 20 and 25 is pressed into the body during manufacture and not available as a spare.

** There is no erosion deflector on vertical traps.

How to Order

Always order spares by using the description given in the column headed Available Spare and stating the size and type of trap, including whether horizontal or vertical connections.

Example: 1 — Air Vent Assembly for DN 20 SPIRAX SARCO FT 43 Steam Trap, with horizontal connectors.

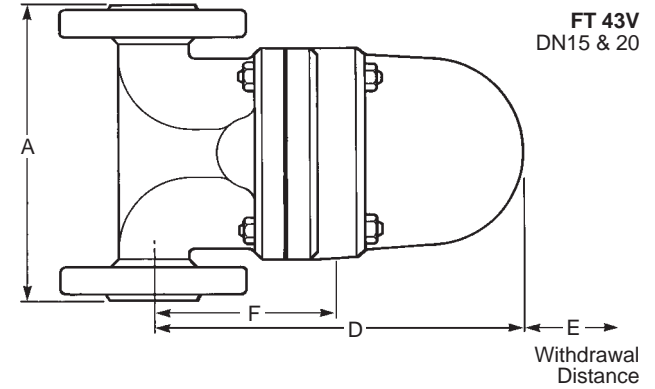
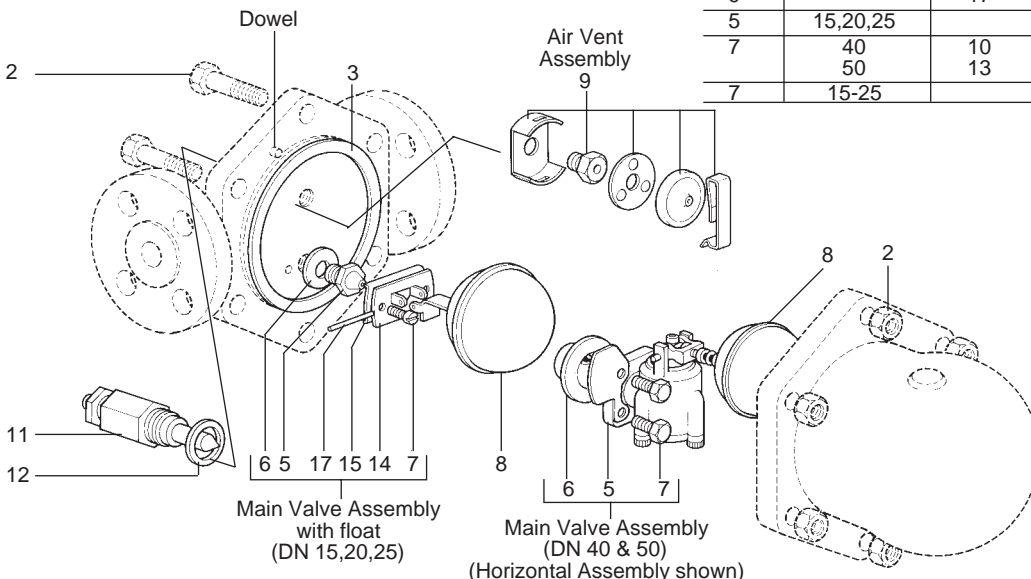

FT 43V
DN15 & 20

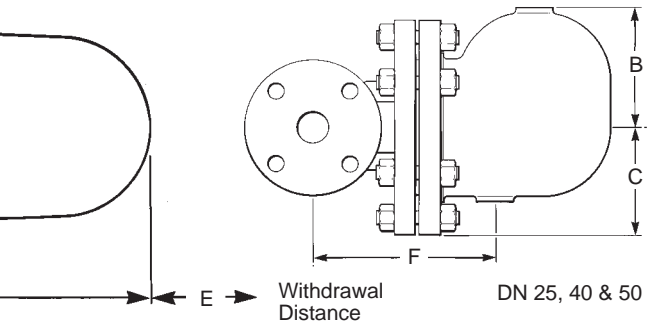

Servicing

With suitable isolation, repairs can be carried out with the trap in the line. When re-assembling, make sure that all joint faces are clean and the dowel locates in the cover.

How to Fit Main Valve Assembly

DN 15, 20, 25, unscrew support, pivot frame and valve seat. Ensure seat/gasket faces are clean and dry. Fit the valve seat to the body. (Do not use gasket paste).

Attach the support frame and pivot frame to body with assembly set screws but do not tighten.

Fit the float arm to the pivot frame using the pin and by moving the complete assembly centre the valve head onto the seat orifice. Tighten the assembly set screws.

DN 40 and 50:- unscrew the 4 bolts or nuts. Remove the main valve assembly and replace with new one. Tighten the bolts or nuts evenly.

How to Fit Air Vent Assembly

Remove spring clip, capsule, spacer plate and unscrew seat. Fit new seat and frame. Assemble spacer plate, fit capsule, and clip.

Recommended Tightening torques

Item	Size DN	mm or	Nm
2	15,20,25	17	29-33
	40	24	60-66
	50	24	80-88
11		22	40-45
		17	50-55
9	15,20,25		50-55
7	40	10	10-12
	50	13	20-24
7	15-25	M5 x 20	2.5-2.8